

USED BOAT SPECIAL: TOP PERFORMANCE BOATS FROM £23,995

MOTOR BOAT & YACHTING

35ft OF CRUISING GOLD

NEW BÉNÉTEAU SWIFT TRAWLER 35

*Pushed to the max
over 48 hours*



WINDY 27 SOLANO



AZIMUT 60



OUTER REEF 630



PARDO 43

16
HOT NEW
BOATS
FOR 2018



*What boat
does the boss of
a shipyard buy?*
IT'S NOT WHAT YOU THINK!

Princess 62
FULL TEST OF THIS
FAB NEW FLYBRIDGE

Wonder hull
THE BEST NEW DESIGN
SINCE THE DEEP VEE?

Azimut 60

After years of making sure the interiors of all its boats had the same distinctive Azimut family look, the yard has now invited designers to create different interiors for each of its new models. Step from this new 60 on to the recently launched S7 sports cruiser and you would barely even know they were related. It's a brave move that ensures customers feel they are getting a more bespoke, designer-led look rather than a one-size-fits-all boat.

Achille Salvagni is responsible for the new 60's interior, with a brief to bring a new style borrowed from residential architecture. The flybridge table has a marble top set in a teak surround while the lime green headboard in the VIP cabin has globe lights built into the wings. There is a playfulness to the design but it has resulted in some unusual layout decisions – in the full-beam owner's cabin, the bed runs across the beam facing a large curved chest of drawers set back from

Cutaway bulwarks give an uninterrupted view from the main-deck dining area

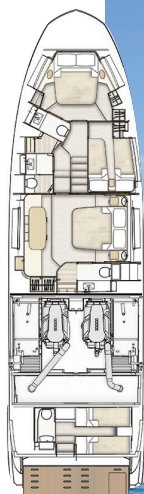

HIGHLIGHTS

- Designer detailing
- Vacuum-infused hull
- Colourful interior

hull window. The third cabin is a twin with a separate bathroom that doubles as a day heads.

The exterior is more predictable, with floor-to-ceiling windows, cutaway bulwarks and a more vertical bow.

A vacuum-infused hull powered by 800hp MANs or 900hp Volvos on

straight shafts will please traditionalists, while active trim control and electronic power steering with variable assistance should ensure it's fun and easy to handle.

Contact Azimut Yachts UK.

Tel: +44 (0)1489 886663.

Web: www.azimutyachts.com



Plenty of designer touches in the saloon as well as the cabins



Outer Reef 630

Built for an experienced owner wanting to explore the Med at his leisure, this first European 630 is set up for short-handed operation but has room for his children and their families to stay when needed.

To maximise the skipper's vision and ensure everybody feels part of

the action, he opted for a large open galley in the middle of the saloon with seating next to the central helm in addition to the main dining and seating area further aft. Internal stairs lead up to the full-length flybridge, which is so big it has been divided into a cosy socialising space under

The master cabin has full standing headroom and lots of storage

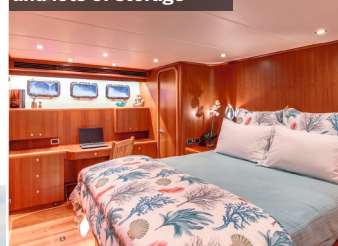

the hardtop on the raised forward section and a large open aft deck with crane, teak sun loungers and room for the Williams 385 tender.

Below, the full-beam owner's suite, forward VIP and twin guest cabin all enjoy full standing headroom and impressive amounts of storage. The only compromise is that guests have to share the VIP's ensuite bathroom although this, like every aspect of the layout, can be changed to suit the owner's needs. Somehow this still leaves space for an astonishingly spacious engine room and crew quarters that would be the envy of most 80-footers. No wonder Outer Reef is becoming the go-to brand for custom-built long-range motor yachts.

Contact Outer Reef Yachts.

Tel: +44 (0)1489 589194.

Web: www.outerreefyachts.com

HIGHLIGHTS

- Full custom interior
- 3,785-litre fuel tanks
- Spacious engine room



The 630 can be handled by a couple but has room for guests and crew

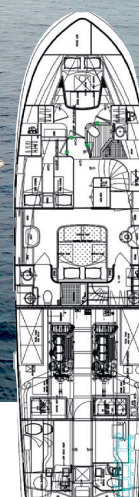

AT A GLANCE

Length 63ft 0in (19.2m)

Beam 17ft 2in (5.2m)

Engines 2 x 500hp CAT or John Deere

Top speed 14.5 knots

Price from €1.8m ex tax